



LPG PRESSURE REGULATOR

RN86



MEMTEX Ltd.
Sofia, Bulgaria
tel: +359 2 8574063, fax: +359 2 9590513
E-mail: office@memtex.net
www.memtex.net

Technical data

Reducer Type	Single stage, compensated
Input Pressure	to 3000 kPa
Output Pressure	Variable from 80 to 180 kPa (when tested non connected to the engine)
Max. Input Pressure	6750 kPa (ECE 67R – 01)
Gas inlet	M10x1, brass union
Gas outlet	Ø12
Water union	Ø12
Dimensions	108 x 120 mm
Weight	0,65 kg
Engine power	Suitable for engines up to 110 KW (145 PS) operating at ambient temperature not lower than -10° C. In case of operation at temperatures permanently higher than the indicated limit, the LPG reducer can be used on engines having power exceeding the range above indicated . The power have to be decreased than the indicated limit for the regions with colder climate.
All other functional and environmental characteristic	According to Regulation ECE 67R - 01

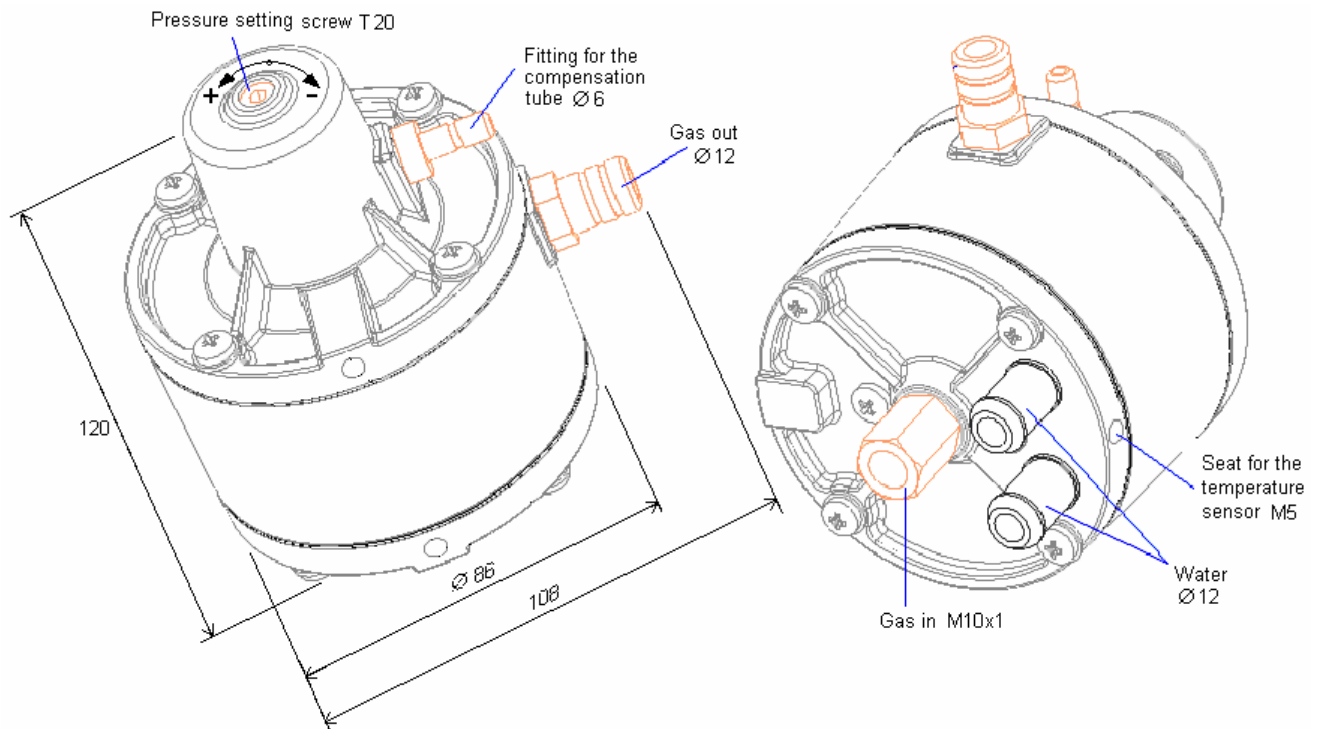

MEMTEX Ltd.

Sofia, Bulgaria

tel: +359 2 8574063, fax: +359 2 9590513

E-mail: office@memtex.net

www.memtex.net